

POWERSUPPLIES

DR-60, Switching powersupply, 32-60W

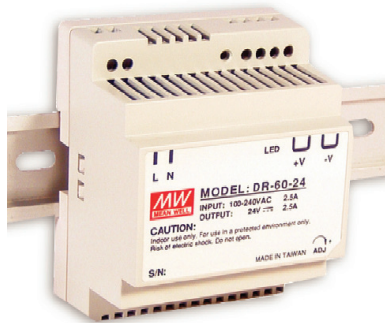

- DIN-rail mounting, TS35 / 7.5 / 15
- LED indicator for power on
- Adjustable output voltage
- UL 508 listed
- 3 years warranty

Technical data:

Input:

Input voltage: 85-264VAC / 120-370VDC
 Frequency: 47-63 Hz
 Input current at 230VAC: 1A
 Inrush current at 230VAC: 36A

Output:

Output voltage: See below table
 Output current: See below table
 Adjustable output voltage: +/-10%
 Overload protection: 105%-160% constant current limiting, auto-recovery
 Over voltage protection: 115%-135% rated output voltage
 Line regulation 90-264V: +/-1%
 Load regulation 0-100% load: +/-1%
 Ripple & noise: 80-150mV depending of model
 Efficiency: 76-86% depending of model
 Temperature range: -20°C...+45°C@100% +60°C@60%
 Connection: Screw terminals
 Size: 78x93x56 mm
 Weight: 300g
 Safety and EMC: UL/cUL/TÜV/CE/CB

Mechanical drawing:

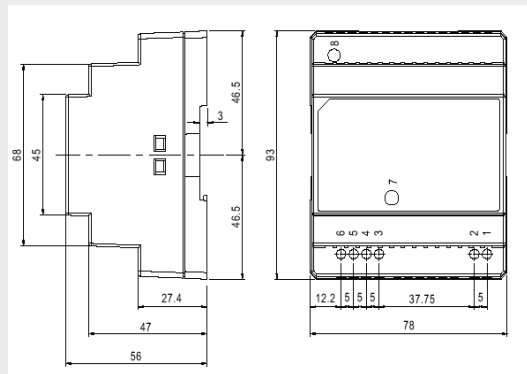

Terminal Pin. No Assignment

Pin No.	Assignment	Pin No.	Assignment
1	AC/N	5,6	-V
2	AC/L	7	LED
3,4	+V	8	+VADJ.

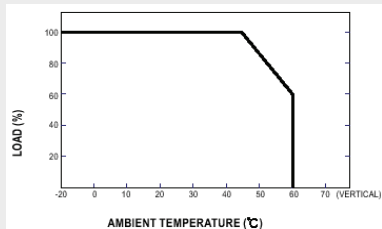

Ordering information:

Type	Power	Output voltage	Output current
DR-60-5	32W	5VDC	6.5A
DR-60-12	54W	12VDC	4.5A
DR-60-15	60W	15VDC	4.0A
DR-60-24	60W	24VDC	2.5A