

POWERSUPPLIES

DR-30, Switching powersupply, 15-36W



- DIN-rail mounting, TS35
- LED indicator for power on
- Adjustable output voltage
- UL 508 listed
- 3 years warranty

Technical data:

Input:

Input voltage:	85-264VAC / 120-370VDC
Frequency:	47-63 Hz
Input current at 230VAC:	0.6A
Inrush current at 230VAC:	30A

Output:

Output voltage:	See below table
Output current:	See below table
Adjustable output voltage:	+/-10%
Overload protection:	105%-160% constant current limiting, auto-recovery
Over voltage protection:	115%-135% rated output voltage
Line regulation 90-264V:	+/-1%
Load regulation 0-100% load:	+/-1%
Ripple & noise:	80-150mV depending of model
Efficiency:	74-83% depending of model
Temperature range:	-20°C...+60°C
Connection:	Screw terminals
Size:	78x93x56 mm
Weight:	270g
Safety and EMC:	UL/cUL/TÜV/CE/CB

Mechanical drawing:

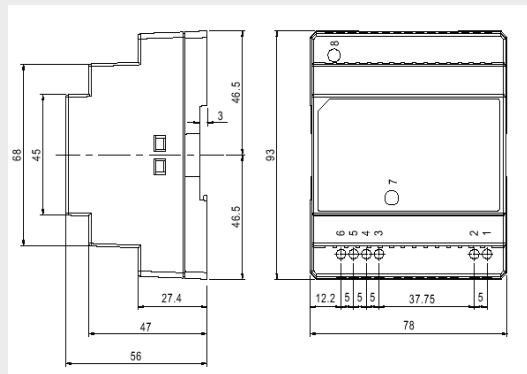

Terminal Pin. No Assignment

Pin No.	Assignment	Pin No.	Assignment
1	AC/N	5,6	-V
2	AC/L	7	LED
3,4	+V	8	+VADJ.

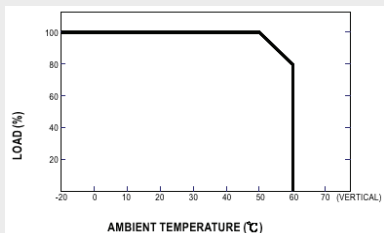

Ordering information:

Type	Power	Output voltage	Output current
DR-30-5	15W	5VDC	3.0A
DR-30-12	24W	12VDC	2.0A
DR-30-15	30W	15VDC	2.0A
DR-30-24	36W	24VDC	1.5A